



ZOJIRUSHI

Household Use Only

Instruction Manual

Stainless Tea Tumbler with Handle

Model No. SE-KAE

Please read these instructions before use,
and keep for future reference.

● Be sure that all parts are attached
firmly before each use.

Name of Each Part

Lid Set

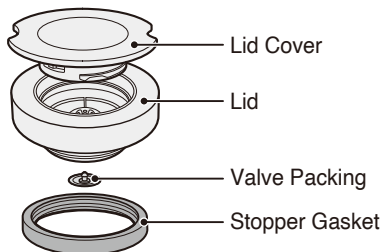

Strainer

Infuser Set

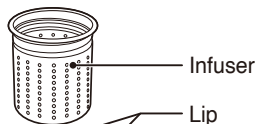
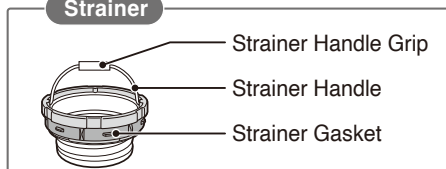

Main Body

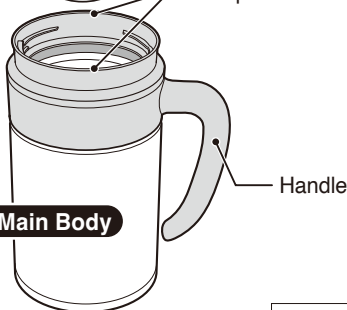

● The illustrations used in this instruction manual may vary from the actual product you have purchased.

Important Safeguards

Do not allow infants or small children to use the product. Keep out of the reach of infants and small children.

Mishandling may cause scalding or other injury.

Do not use near open flames from sources such as stoves.

Doing so may cause scalding or damage, deformation or discoloration of the product.

Do not disassemble the Main Body.

Do not use the product while driving.

Doing so may cause scalding or stain the interior of your car or clothes. Attempting use of the product while driving also poses a serious risk accident.

Make sure to close the Lid Set securely after use.

Beverages may leak and cause scalding or stain clothes.

Do not use the product if it loses its heat retention properties.

The outside of the Main Body will become very hot when filled with a hot beverage and may cause scalding.

Use only to keep beverages hot or cold.

This product is for keeping beverages hot or cold.

Avoid leaving the product in direct sunlight for extended periods of time.

Doing so may cause discoloration of the product.

Do not place cans or bottles inside the Main Body.

Doing so may result in product damage, deformation, or malfunctioning.

Consume beverages within the same day to prevent spoilage.

Leaving beverage in the product for an extended period of time may cause spoilage and increase gas pressure inside the Main Body, causing the Lid Set to pop off and the beverage to spill, or damaging the Lid Set or other parts causing them to fly off the product.

Do not heat the product in a microwave.

Doing so may cause sparks or deform or discolor the product.

Fill the product to the level shown in the illustration.

Filling over the level shown will cause the beverage to overflow when closing the Lid Set. It may also cause the beverage to leak later.

When using the product without the Infuser Set or Strainer

When using the product with the attachments

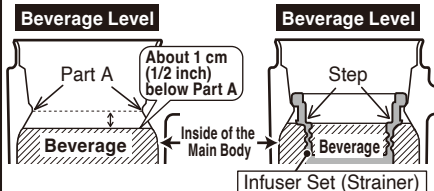

When filling the product with a hot beverage:

- **Be careful to avoid scalding yourself when using the product.**

The product will keep beverages hot for hours while remaining cool to the touch.

- **Drink slowly without tilting the Main Body suddenly.**

There is a possibility that the beverage may spill, cause burns and stain clothes.

- **Do not shake the product.**

Doing so may cause scalding or other injury.

- **Always use with the Lid Set Cover in place.**

The interior of the Lid Set may become hot, causing scalding or other injury.

- **Do not touch metal parts when attaching or removing the Strainer.**

Doing so may cause scalding.

Do not use if water gets into the Vacuum Layer.

- When filling the product with a hot beverage, the outside of the Main Body may become very hot, causing scalding.

- Drinking water that leaks from the Vacuum Layer may cause illness.

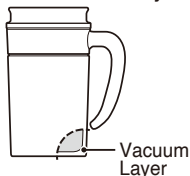

Always use the product with the Lid Cover, Lid, Valve Packing, and Stopper Gasket attached.

Failure to do so may cause contents to leak, resulting in scalding or stains.

- Please follow these instructions to prevent scalding, deterioration and discoloration of beverages, and malfunction or staining of the product.

Exercise caution when removing the Strainer as the Strainer Handle may be hot.
Failure to do so may cause scalding.

Hold the handle firmly when carrying the product.

- **Do not tilt the product or carry it on its side.**
Doing so may cause scalding or stains.
- **Do not carry the product by the Strainer Handle.**
The Strainer may come off and cause the Main Body to fall, posing a hazard.
- **Do not carry the product by the Lid Set.**
The Main Body could fall, posing a hazard.

Wash the Lid Set, Infuser Set, and the interior of the Main Body immediately after every use.

- **Although the Main Body is made of 18/8 stainless steel, salt from drinks such as sports drinks may cause rust, resulting in loss of thermal insulation.**
- **Not cleaning thoroughly may cause contents to spoil, mold, odor or discoloration. It may also cause the beverage to leak.**
- **A buildup of pressure inside the Main Body from gases given off by a beverage as it spoils may make the Lid Set fly off or burst when it is opened, causing foods or beverages to spray out and cause injury.**
- **Clean the product with a soft sponge to protect the stainless steel surface from getting scratched.**
Scratches may cause rust, pinholes or other damage.

Do not place the product in the freezer.
Doing so may damage the product.

Do not place the product near open flames (from gas stoves) or on top of electric heaters or IH cooking devices.
Doing so may result in fire or cause the product to malfunction.

Do not fill the Main Body with the following:

- **Dry ice and carbonated drinks:**
A gas pressure increase inside the Main Body may cause the Lid Set to fly off and the beverage to spill or damage the Lid Set or other parts, resulting in danger.
- **Dairy products and fruit juice:**
If left inside for a long period of time, contents may spoil and produce gas that may cause the Lid Set to burst, causing injuries.
- **Liquids high in sodium such as soup or Kobu-cha:**
Although the liner is made of 18/8 stainless steel, salt could cause rust, resulting in loss of thermal insulation.
- **Fruit pulp:**
Contents could clog the Stopper Gasket or cause leaks.

Do not remove the sticker on the bottom of the Main Body.

Doing so may cause rust, pinholes or other damages.



Do not heat the product from the outside if you have difficulty removing the Lid Set.

Doing so may increase the pressure inside the Main Body and cause the Lid Set to fly off, beverages to spray out, or damage the Lid Set or other parts and cause them to fly off. If you have difficulty removing the Lid Set due to pressure built up inside the Main Body, follow the instructions "If you have difficulty removing the Lid Set" on p. 7 to release pressure and remove the Lid Set.

- The stainless steel Main Body and Infuser Set may give off a metallic odor. This is a normal property of stainless steel.

Warnings & Cautions

Do not scrape or rub the design on the Main Body with your fingernails or hard objects.
Doing so may cause the design to peel off.

Do not attach parts other than those specifically designed for use with this product.
Doing so may cause leaks or breakage.

Do not allow a hot kettle to touch the Lip of the product.

Doing so may cause scalding if the product overturns. It may also cause scratches or deformation of the Lip of the product.



Warnings & Cautions (continued)

The product is designed to drink directly from it. Pouring contents into another container may result in splatter.

Leaving hot tea in the product for an extended period of time may cause discoloration of the product. Drink contents sooner rather than later.

Do not strike the product with an ice pick or other sharp object.

Doing so may damage the product and reduce its ability to maintain heat.

If you place something with a strong odor in the product, the odor may be transferred.

If the product has a strong odor, see p. 10 "Troubleshooting Guide."

Avoid dropping the product or subjecting it to mechanical shock.

Damage to the plastic or stainless steel surface of the product may reduce its ability to maintain heat.

- Do not place objects directly on top of the Lid Set. Doing so may cause the objects to absorb heat from the Lid Set.
- Stand the Main Body upright when opening or closing the Lid Set.
- When carrying the product in a bag, keep it upright to prevent any leakage of contents.



After washing the Lid Set, remove all water from product parts by shaking them repeatedly and wiping them before reassembly.

Water may collect inside the Lid Set and may drip out if not allowed to dry thoroughly.

(See "How to Disassemble" on p. 4-5.)

How to Disassemble

■ Lid Set

- 1 Rotate the Lid Cover and remove it as shown in the illustration**

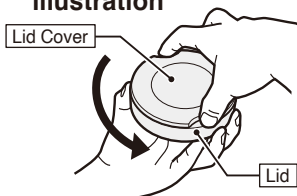

- 2 Remove the Stopper Gasket**

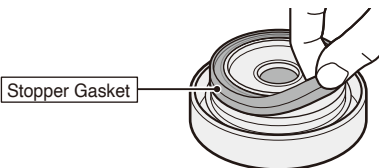

- 3 Remove the Valve Packing**

The Valve Packing is fitted into the center of the Lid. Remove it using your finger and thumb as shown in the illustration.

Valve Packing

When removing the Valve Packing, be careful not to damage it with your fingernails.

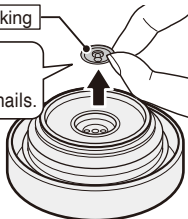

- The Lid Set has a hollow structure for insulation purposes. Remove the Lid Cover and clean inside the cavity.

How to Disassemble (continued)

■ Infuser Set

- 1 Rotate the Infuser as shown in the illustration

Be sure to allow the Infuser to cool before removing it.

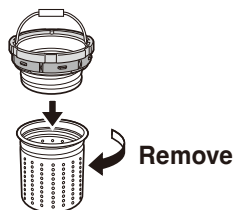

- 2 Remove the Strainer Gasket

Grip this part of the Strainer Gasket when removing it. Be careful not to damage the Strainer Gasket.

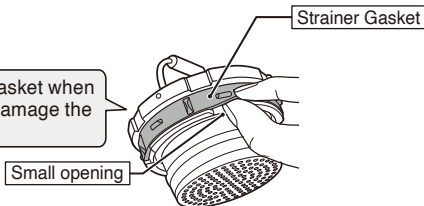

How to Assemble

- Be sure to attach the Lid Cover, Lid, Valve Packing, Stopper Gasket, Strainer Gasket, and Infuser properly. (Failure to do so could result in improper operation or leakage of beverages.)

■ Infuser Set

- 1 Attach the Strainer Gasket with the tab facing outward

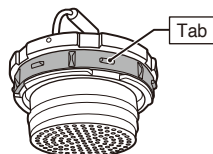

- 2 Attach the Infuser

Rotate the Infuser as shown in the illustration to attach.

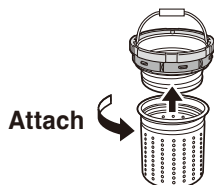

How to Assemble (continued)

Lid Set

1 Attach the Stopper Gasket

Match the recess on the Stopper Gasket with the ridge of the Lid and push into place while applying pressure from the outside in.

Do not attach the Stopper Gasket upside down. (Doing so may cause beverages to leak.)

Always attach with this part facing upwards.

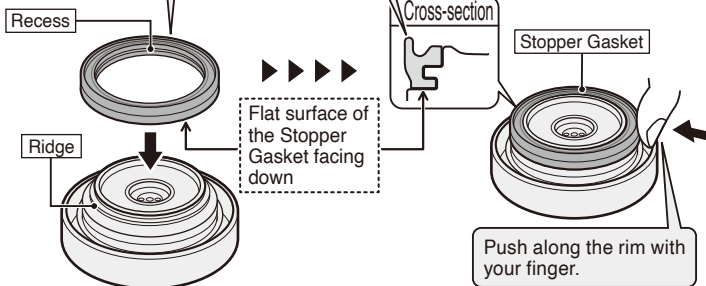

2 Attach the Valve Packing

As shown in the illustration, push the protruding part of the Valve Packing securely into the hole in the center of the Lid.

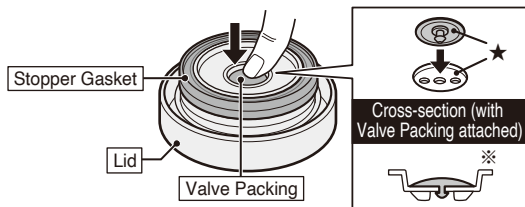

★ Foreign matter or dirt stuck to the underside or protruding part of the Valve Packing may cause beverages to leak.

※ There are three holes in the Lid. Insert the protruding part into the center hole.

● Beverages may leak if the Valve Packing is not correctly attached.

3 Attach the Lid Cover

Rotate the Lid Cover as shown in the illustration to attach it.

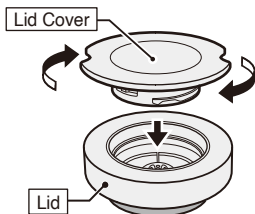

Using the Product

- Before use, rinse the Lid Set, Infuser Set, and the Main Body thoroughly with lukewarm water.
- The first time you use the product you may notice the smell of plastic. This is normal and will gradually fade away.

1 Remove the Lid Set and Infuser Set from the Main Body

- ① Remove the Lid Set from the Main Body by turning it counterclockwise as illustrated.

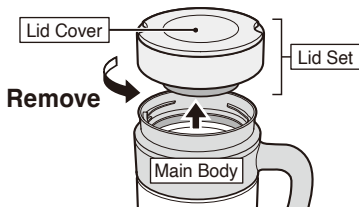

- Do not remove the Lid Cover only. Make sure to remove the entire Lid Set.

- ② Remove the Infuser Set.

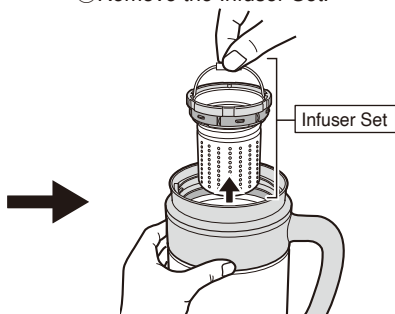

- Hold the Main Body firmly.

If you have difficulty removing the Lid Set

Pre-heating the Main Body or filling it with hot beverages may cause a buildup of pressure inside the Main Body and make the Lid Set difficult to remove. In this case, remove the Lid Cover and push a small stick with a rounded tip or similar tool into the two holes in the center of the Lid to release pressure. Take care not to damage the Valve Packing when pushing down on the Valve Packing. (See illustration to right.)

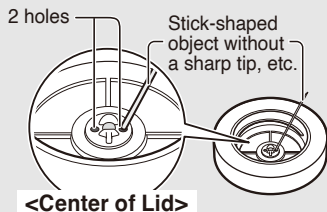

2 Pre-heat (pre-cool) the product

For better heat retention, pre-heat (pre-cool) the Main Body for about 1 minute by filling it with hot (cold) water before filling with your beverage.

When using the product without the Infuser Set or Strainer

Beverage Level

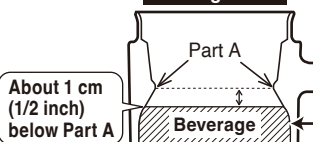

When using the product with the attachments

Beverage Level

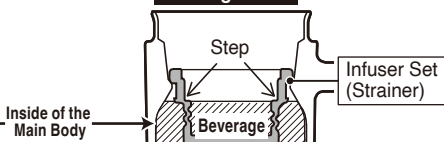

3 Pour beverage into the Main Body

① Remove the Infuser from the Infuser Set.

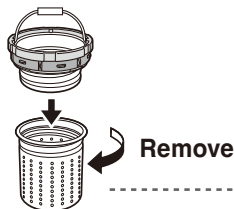

② Add tea leaves.

If using the Infuser Set

Put tea leaves in the Infuser and attach the Strainer.

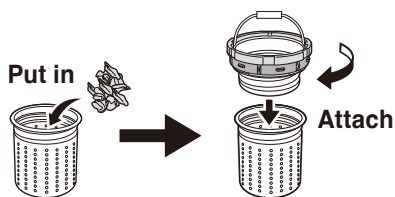

●Firmly close the Strainer.

If using the Strainer only

Add tea leaves to the Main Body.

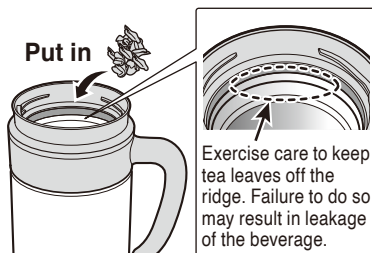

●Do not place the tea leaves on top of the Strainer.

③ Attach the Infuser Set (or Strainer) to the Main Body and fold down the Strainer Handle.

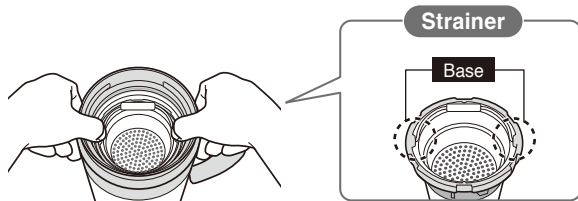

●Press down on the edge of the Strainer (the base of the Strainer Handle) to fit in place.

④ Pour hot water into the Main Body and close the Lid Set.

- Be sure that the Lid Cover, gaskets, and packings are attached properly before use. (Otherwise, the beverage may leak.)
- Holding the Main Body upright, close the Lid Set firmly.
- Attach the Lid Set properly and turn the product upside down to make sure contents do not leak.
- If there are too many tea leaves or too much hot water, discard a small amount and close the Lid Set. (Refer to “Beverage Level” on p. 2.)
- Hot water may splatter when filling. Exercise care to avoid scalding.
- Do not touch metal parts when attaching the Strainer to the Main Body. Doing so may result in scalding. Exercise care to avoid scalding due to steam.
- Add hot water until it reaches the tea leaves.

4 Open the Lid Set and drink from the product with the Infuser Set or Strainer attached

- Drink from the Lip of the product.
- Fine tea leaves that are smaller than the Holes in the Infuser or Strainer may flow out of the product with the beverage.
- When drinking with the Infuser Set or Strainer attached to the product, verify that the Infuser Set or Strainer is securely attached before drinking.
- Fold down the Strainer Handle before drinking from the product.
- When removing the Infuser Set or Strainer from the product, exercise care to avoid scalding as the Strainer Handle may be hot. Hold the Strainer by the Strainer Handle Grip when removing it.

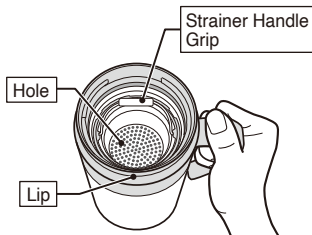

You can place the Infuser Set on the Lid Set.

- When placing the Infuser Set on top of the Lid Set, make sure to drain water well in advance.

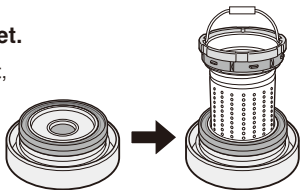

5 After drinking, close the Lid Set by rotating it clockwise

- Make sure the Strainer Handle is folded down when closing the Lid Set.
- Do not carry the product by the Strainer Handle. The Strainer may come off and cause the Main Body to fall, posing a hazard.

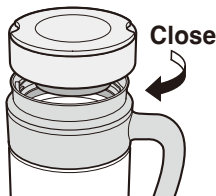

Troubleshooting Guide

Problem	Cause	Solution
Beverages leak from the Lid Set.	Are the Valve Packing and Stopper Gasket securely attached?	Check the location and orientation of the Valve Packing and Stopper Gasket and verify that there are no gaps between them. (See “How to Assemble” on p. 5-6.)
	Is there any residue or tea leaves on the Lid, Valve Packing, or Stopper Gasket?	Clean the product while referring to the instructions. (See “Caring for Your Product” on p. 11-12.)
	Has the product been overfilled?	Discard a small quantity so that the product contains the proper quantity. (See “Beverage Level” on p. 2.)
	Did any water get into the space between the Lid Cover and Lid when washing the product?	Wipe dry any water that has collected between the Lid Cover and Lid.
The beverage, Lid Set, Infuser Set, or the interior have an odor.	Did you leave the beverage in the product for an extended period of time? Is there any residue, such as tea stains in the interior? Did you fill the product with a beverage with a strong scent?	Clean the product. If you have difficulty removing any residue, use a detergent for cleaning stainless steel containers. (See “To Remove Coffee and Tea Stains” on p. 12.)
The product doesn't keep contents hot or cold.	Is the liquid you are placing in the Main Body sufficiently hot or cold? Alternatively, are you filling the Main Body with too little of the beverage?	Fill the Main Body to the correct level with liquids that are sufficiently hot or cold. (See “Beverage Level” on p. 7.)
	Did you pre-heat (pre-cool) the product?	Pre-heat (pre-cool) the product. (See “2. Pre-heat (pre-cool) the product” on p. 7.)
The Lid Set doesn't close.	Is the Strainer Handle in the raised position?	Fold down the Strainer Handle.
A rattling noise can be heard when the Main Body is shaken.	The noise comes from the metallic foil in the vacuum insulation to increase heat (cold) retention and does not indicate a malfunction.	

Caring for Your Product

- Clean the product after each use to prevent odors and mold, and to keep the product sanitary.
- Always disassemble the product before cleaning. (See “How to Disassemble” on p. 4-5.)

Lid Set, Exterior of the Main Body and Infuser Set

- ① Wash with warm water and mild dishwashing liquid using a soft sponge.
- ② Rinse, shake a few times and wipe dry.
 - When washing the Lid Set and Infuser Set, disassemble all parts first then wash and dry.
 - After cleaning, reassemble the parts. (See “How to Assemble” on p. 5-6.)
 - Use a small brush sold in stores if necessary.
 - Continued use with tea leaves may cause the interior to become stained and discolored. Although it may not be possible to completely remove such discoloration, it will not affect use.
 - Wipe off any fingerprints with a dry cloth.

Interior

- ① Wash with warm water and mild dishwashing liquid using a small sponge with a handle.
- ② After rinsing the Main Body, wipe away any moisture and allow it to dry.
 - Keeping the inside clean will help prevent odors.

- Streaks or smudges caused by rubbing on the coated portion of the Main Body can be removed using a soft eraser.

When Cleaning Your Product:

- Do not use a dishwasher or dish-dryer. Do not boil to sanitize.
- Do not clean using paint thinner, metal wire scrub brushes, scrubbing brushes that include abrasive cleaners, polishing powders, cleansers, or similar items. Doing so may damage the product.
- Do not use chlorine-based bleach. In addition, do not use any kind of bleach, even non-chlorine-based, to clean the outside of the Main Body. Such bleach-based products may damage the paint, print, or stickers on the Main Body.
- Do not soak in water for an extended period of time.
- If the product is not going to be used for an extended period, wash thoroughly with cold or lukewarm water and dry well. Store the product away from high temperatures and humidity.

High temperatures and humidity may damage the product.
- After washing the product, wipe away any moisture between the Lid Cover and Lid.
- Do not push or pull on the Main Body Gasket. Doing so may result in leakage of contents or damage the gasket.

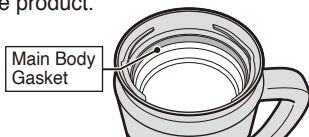

To Remove Rust Spots and Water Stains:

You may find rust spots or water stains caused by the water quality or impurities in the water inside the Main Body. To remove these stains, fill the Main Body with hot water with 10% vinegar and allow to stand for 30 minutes to an hour without attaching the Lid Set or Infuser Set. Then wash the inside of the Main Body thoroughly.

(See “Caring for Your Product” on p. 11-12.)

To Remove Coffee and Tea Stains:

To remove coffee and tea stains from the interior and the Lid Set, we recommend using Zojirushi's cleaning detergent SB-ZA01E (sold separately).

- Always remove the Lid Set from the Main Body when using Zojirushi's cleaning detergent.

We take care in only using materials that are safe and hygienic for food contact. However, if plastic parts become damaged or their surface becomes rough, please replace them for optimum performance. The Lid Set, Stopper Gasket, Valve Packing, and Infuser Set may need to be replaced due to time and wear. Please check them about once a year. When replacing parts, please record the model number and part name beforehand. Then contact either the store where you purchased the product or Zojirushi Customer Service. Replacement parts may be available for an additional charge.