



For Household Use Only

STAINLESS STEEL LUNCH JAR

INSTRUCTION MANUAL

Thank you for your purchase of this quality Zojirushi product. We are confident that it will give you top performance and optimum satisfaction for many years. To ensure this, please read and follow the important guidelines below.

● Be sure that all parts are attached firmly before each use.

Be sure to follow the instructions.

This product is for keeping rice and soup*¹ warm or cold. Do not use for other purposes.

(※1) Only applicable to products with a soup bowl set

● To prevent scalding, deterioration and discoloration of food, or damages to the product, please read and follow the important guidelines below.

- | | |
|--|---|
| <ul style="list-style-type: none"> ■ Keep out of the reach of infants and small children. Do not allow them to play with this product. They may scald or otherwise injure themselves. | <ul style="list-style-type: none"> ■ Keep away from heat sources such as gas stoves, ovens and heaters. Doing so may cause deformation or discoloration. |
|--|---|
-
- When placing inner bowls in the microwave, please:
 - * Remove all lids from the inner bowls. The lids are not microwave safe.
 - * Do not microwave the outer container. Doing so may produce sparks and be dangerous.
 - * Do not use the grill function when using a grill & convection type of microwave oven. Allow microwave to cool when using it consecutively. Doing so may cause the inner bowls to deform resulting in breakage.
 - * Do not microwave the inner bowls when there is nothing inside. Doing so may deform the bowls.
 - * Do not microwave oily food or food rich in sugar for a long period of time. Doing so may cause the temperature of inner bowls to become too high and deform, resulting in breakage.
 - Do not leave the product on its side (contents may spill).
 - Do not leave food in the product for a long period of time. Doing so may cause contents to spoil.
 - Do not include foods that deteriorate or spoil easily such as raw food and dairy products. The pressure of the gas created by spoiled food may damage or deform the inner bowls.
 - Please avoid storing liquids in the main bowl or side bowl for it may spill.
 - Do not place any food directly in the outer container. Doing so may cause the container to rust.
 - Cool foods to room temperature when storing in the side bowl. Closing the side bowl lid while the content is hot may cause deformation or cause contents to spill.
 - Clean the inside of the outer container to prevent from rusting.
 - Do not store rice cooked with additional ingredients and seasonings such as mixed rice or fried rice. Doing so may lead to spoiling.

CAUTIONS

- Do not carry by the lid. The lid may come off and the product may drop.
- Wash inner bowls, lids, chopsticks and chopsticks holder before initial use.
- Please place inner bowls in the following order: Soup Bowl*¹→Main Bowl→Side Bowl
- Avoid dropping or hitting against hard surfaces. The plastic parts may break or the outer container may dent resulting in damage to the heat retention.
- Wrap food with cling-wrap or aluminum foil if they have a strong smell and color such as spinach, pickles, perilla or carrots.
- Consume foods within 6 hours to keep foods from spoiling.
- When filled with hot soup, the soup bowl may expand and the lid may become difficult to open. If this happens, press gently through the holes at the center of the lid with a thin stick to release the inner pressure. (※1)
- Do not place a main bowl containing hot food (or cold food) and a soup bowl*¹ containing cold food (or hot food) together in the outer container, or do not put hot food and cold food in one bowl at the same time.
- Do not scratch the printing on the outer container with nails or hard elements. Doing so may cause damage.
- Always clean the container and gasket thoroughly after use. Not doing so may cause decay, mold, odor, or discoloration. It may also cause leaks.
- Do not attach parts other than those specifically for this product. Doing so may cause leaks or breakage.
- The rattling noise that may be heard when the outer body is shaken comes from the copper or aluminum foil in the vacuum insulation to increase heat retention and does not indicate a malfunction.
- The product may not sufficiently keep the content warm if the product is used without hot soup put into the soup bowl. The heat retention effect of the product will be enhanced if hot water is put into the soup bowl if no soup needs to be kept warm.

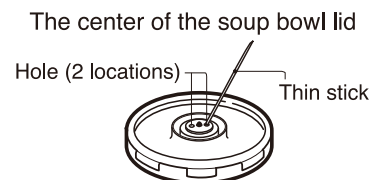

(※2) Only applicable to products with a bag

- Do not machine wash or hand wash the bag. Doing so may damage the cloth or coating.
- Store the bag in a well-ventilated area when it is not in use. If the location is humid, the cloth may become wrinkled.

HOW TO REMOVE/ATTACH THE SOUP BOWL GASKET (※1)

■To Remove:

Remove the soup bowl gasket from the inside by using a pin or a small object and fitting it into the small opening.

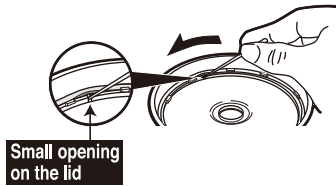

■To Attach:

Fit the soup bowl gasket around the inside of the inner lid by pushing it in with your fingers.

*If the gasket is twisted or warped, fit it in straight with your fingers. A twisted gasket may cause contents to leak.

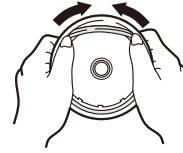

HOW TO REMOVE/ATTACH THE SOUP BOWL VALVE PACKING (※1)

The soup bowl valve packing is located at the center of the soup bowl lid. To remove, pull the valve packing with your fingers as illustrated.

*Be sure to place the valve packing after cleaning.

*Please take caution not to damage the valve packing with your fingernails when removing it.

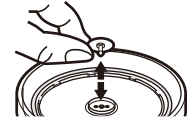

NOTE

We take care in only using materials that are safe and hygienic for food contact. However, if plastic parts become damaged or its surface becomes rough, please replace them for optimum performance. The gasket and packing may need to be replaced due to time and wear. Please check them about once a year. When replacing parts, please record the model number and part name beforehand. Then contact either the store where you purchased the product or Zojirushi Customer Service. Replacement parts may be available for an additional charge.

CLEANING AND MAINTENANCE Be sure to clean after each use.

Outer Lid Main Bowl Side Bowl Set Soup Bowl Set ※1 Chopsticks Holder Chopsticks	Wash with warm water and mild dishwashing liquid, rinse and dry. *Remove and wash the gasket after each use. *Remove the lid while drying.
Outer Container Main Bowl Lid	① Wash with a sponge soaked in mild dishwashing liquid diluted with warm water, then rinse with running water. ② Wipe it with a dry soft cloth. *Do not soak in water. Doing so may allow water to get inside and remain. *Remove the carrying strap from the outer container to wash.
Carrying Strap Bag ※2	Wipe clean with a well wrung soft cloth soaked in mild dishwashing liquid and warm water.

NOTES FOR HANDLING THE PRODUCT

*When storing the product for a long period of time, wash the product thoroughly with warm water or water, and dry it well. When storing it, avoid humid locations. Doing so may damage the product.

*Do not boil the parts (excluding soup bowl※1). Doing so may cause damage, rust or deformation of the parts.

*Do not place parts in dishwashers or dryers. Doing so may cause scratches or rust, deformation or malfunction of the product.

*Do not clean with thinner, benzene, abrasive cleaners or other harsh cleaners. Doing so may damage the product.

*Do not use chlorine type bleach. Doing so may cause rust and pinholes of the outer container and compromise its heat retention properties.

FOR ODOR PROBLEMS

If the product is kept unwashed for a long period of time or is not cleaned thoroughly, the inner bowls may smell or discolor. In this case, please follow these instructions.

Inside the Outer Container Side Bowl Set Main Bowl Set	Wash thoroughly and dry with a soft cloth. Place in the sun and let dry for 1-2 hours.
Soup Bowl ※1	Boil for a short period of time (2-3 minutes) to remove odors and dry it well. Boiling for too long may cause it to deform.

The illustrations used in this instruction manual may vary from the actual product you have purchased.