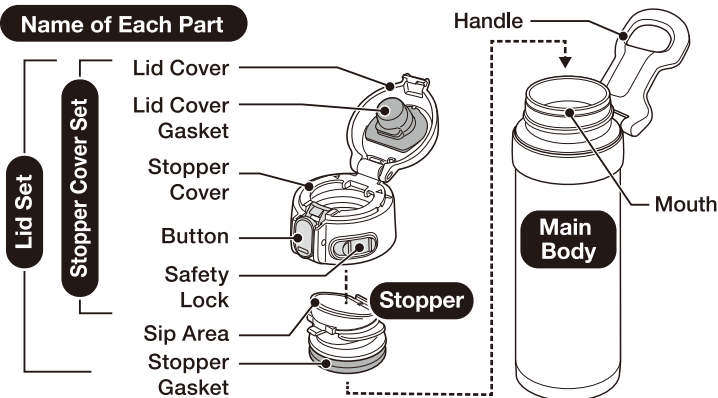

Name of Each Part

- The illustrations used in this instruction manual may differ from the actual product you have purchased.
- Please read these instructions before use, and keep for future reference.

Important Safeguards

Be sure to follow the instructions.

These **WARNINGS** and **CAUTIONS** are intended to prevent property damage or personal injury to you and others.

WARNING

Indicates risk of serious injury or death.

Do not allow infants or small children to use this product. Keep out of the reach of infants and small children.

CAUTION

Indicates risk of injury or property damage if mishandled.

When using filled with a hot beverage:

- Be careful, as it may cause scalding.
- Drink slowly without tilting the product suddenly.
- When pouring hot beverages into the Main Body, be careful not to let it tip over.
- Do not open the Lid Cover with the product close to your face or tilted toward you, as this may cause the beverage to spurt out and scald you.

Do not attach parts other than those specifically designed for this product.

Do not disassemble the product (other than parts designed to be disassembled).

Do not shake the product forcefully.

Do not use the product if its thermal insulation performance has deteriorated.

Do not swing the product around by the Handle.

Do not use if water enters the Vacuum Layer.

Drinking the water that seeps out from the Vacuum Layer may cause illness.

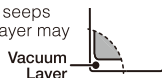

Do not fill the product with the Lid Set attached, as it may overflow.

Do not hold the product by the Lid Set when carrying, as the product may fall and cause injuries.

Do not use this product for other than storing and keeping beverages hot or cold.

This product is designed to be drunk directly, so the beverage may splash if it is used for pouring.

Do not place near heat sources such as gas stoves, ovens, and heaters, as doing so may cause burns or product malfunction.

Do not heat in a microwave, as doing so may cause sparks.

Do not place near open flames (from gas stoves, etc.), on top of electric heaters, or IH cooking devices, as doing so may cause a fire or malfunction.

Avoid dropping or hitting against hard surfaces.

Do not drink out of the product while driving.

Never fill the product with the following:

- Dry ice or carbonated drinks
- Liquids high in sodium such as soup or Kobu-cha
- Dairy products or fruit juice
- Fruit pulp or tea leaves

Do not scratch or rub the design on the outside of the Main Body strongly using fingernails or hard objects, as this may cause the design to come off.

Do not remove the sticker on the bottom of the Main Body.



Fill the Main Body only up to the level shown in the illustration.

Drink Level

Leave a bit of space below the rim (part A).

Inside of the Main Body

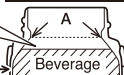

Always make sure that the parts are attached during use.

Make sure that there is no beverage leakage before using the product.

Before using a vehicle drink holder, make sure that the product sits securely inside the drink holder.

Consume beverages within the same day.

Leaving beverages for a long time may cause them to spoil. This may also cause the beverage to come out, or the Lid Set to burst.

Thoroughly clean the inside and Mouth of the Main Body, and the Lid Set after every use. Be particularly careful after filling the product with sports drinks.

After adding hot beverages, the pressure inside the product may rise, making it difficult to remove the Lid Set. If that happens, open the Lid Cover once, then remove the Lid Set.

Break large ice cubes into smaller pieces before adding them, as failure to do so may cause deformation of the Main Body and leakage.

Place the product vertically when carrying it in a bag to prevent leakage or condensation.

Note: The rattling noise that may be heard when the Main Body is shaken comes from the metallic foil used in the vacuum insulation to increase heat (cold) retention, and does not indicate a malfunction.

How to Use:

- Follow the instructions for care and wash the product thoroughly before use.
- When you first use the product, there may be a plastic smell. However, this will become less noticeable with use.

Locking and Unlocking the Safety Lock

- Close the Lid Cover and lock.
 - Do not close the Lid Cover when the Safety Lock is locked.



Opening and Closing the Lid Cover

- How to open



- How to close



How to Disassemble the Lid Set:

1 Remove the Stopper.

With the Lid Cover open, hold the Lid Set and press on the back of the Sip Area (parts indicated by the ▽ marks) to remove the Stopper.

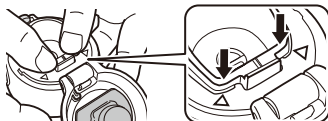

2 Remove the Stopper Gasket.



3 Remove the Lid Cover Gasket.

Pinch the edge of the Lid Cover Gasket and pull it toward you to remove.



How to Assemble the Lid Set:

1 Attach the Lid Cover Gasket.

Align the Small Opening on the Lid Cover Gasket with the protrusion on the Lid Cover.

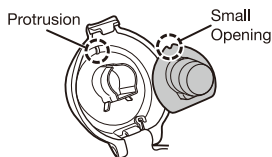

2 Attach the Stopper Gasket.

Line up the recess in the Stopper Gasket with the ridge on the Stopper, and, firmly applying pressure from the outside, push it into place.

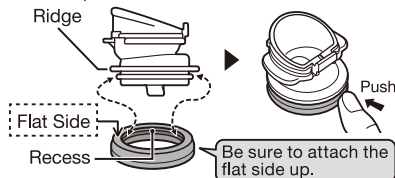

3 Attach the Stopper.

Align the opening on the Stopper Cover Set and the tab on the Stopper, and press the Stopper in to attach it.

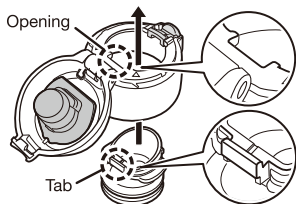

How to Take Care of Your Product:

- Clean the product after each use to prevent odors and mold, and to keep the product sanitary.
- Always disassemble the product before cleaning.

When Cleaning Your Product:

Please follow these instructions to prevent damage to the product:

- Do not boil or use a dishwasher or dish-dryer.
- Do not clean using paint thinner, polishing powders, abrasive cleansers, scrub brushes (nylon, metal wire, etc.), melamine sponges, the nylon side of an abrasive sponge, or any similar items.
- Do not use bleach as it may damage the product. Zojirushi's designated cleaning detergent SB-ZA01E may be used to clean the interior of the Main Body and the Lid Set.
- The Main Body is fully washable, but do not soak it in water for an extended period of time.
- Avoid damaging the inside of the Main Body when cleaning.
- If the product is not going to be used for an extended period, wash thoroughly and dry well. Store the product away from high temperatures and humidity.

How to Clean

- ① Wash using warm water and mild dishwashing liquid with a sponge.
 - ② Rinse, leave to dry so there is no remaining water.
- Use a small brush or a soft sponge brush with a handle to wash parts that are difficult to wash.
 - Streaks or smudges caused by rubbing on the coated portion of the Main Body can be removed using a soft eraser.

How to Clean Rust Spots and Water Stains

- ① Fill the Main Body with hot water with 10% vinegar.
- ② Leave for 30 minutes to an hour without attaching the Lid Set.
- ③ Wash the interior thoroughly.

Tea, Coffee, and Other Stubborn Stains (Main Body interior and Lid Set)

Remove the Lid and use Zojirushi's cleaning detergent SB-ZA01E. (Contact Zojirushi Customer Service or your local dealer for further information.)

Replacing the Lid Set:

We take care in only using materials that are safe and hygienic for food contact. However, if plastic parts become damaged or their surface becomes rough, please replace them for optimum performance. The Lid Set may need to be replaced due to time and wear. Please check it about once a year. When replacing parts, please record the model number and part name beforehand. Then contact either the store where you purchased the product or Zojirushi Customer Service. Replacement parts may be available for an additional charge.