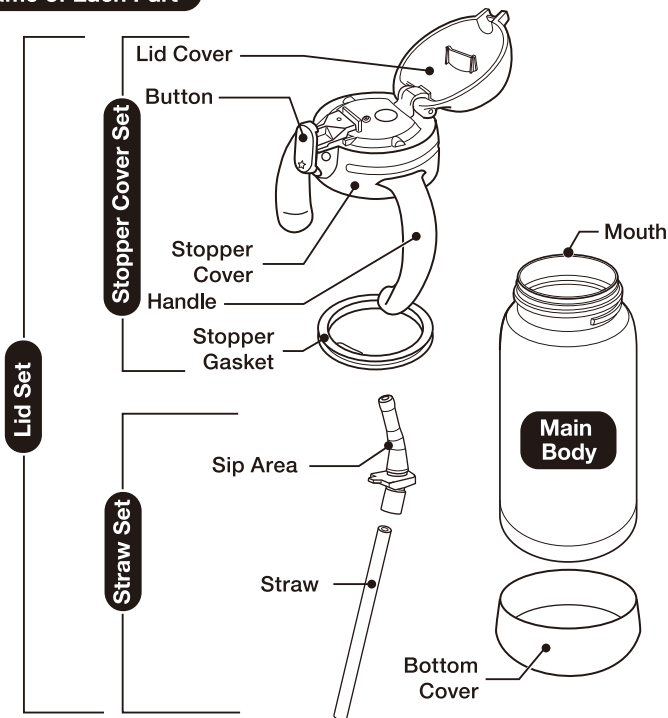

Name of Each Part

- The illustrations used in this instruction manual may differ from the actual product you have purchased.
- Please read these instructions before use, and keep for future reference.

Warning

- Please follow these instructions to prevent injury, scalding, accidents, malfunction or performance deterioration of the product, spilling of beverages, etc.

Keep out of reach of infants and small children.

Never fill with hot beverages.

Each part must be correctly attached by an adult.

Do not attach parts other than those specifically designed for this product.

Do not use the product if its cold insulation performance has deteriorated.

Do not use if you hear the sound of water coming from the interior of the Vacuum Layer.

If the internal water seeps out from the Vacuum Layer, drinking it may cause illness.

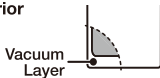

Do not disassemble or modify the product (other than parts designed to be disassembled.)

Do not heat in a microwave, as doing so may cause sparks.

Do not place near open flames (from gas stoves, etc.), on top of electric heaters, or IH cooking devices, as doing so may cause a fire or malfunction.

Do not open the Lid Cover with the product close to your face or tilted toward you.

Consume beverages within the same day.

Spoiled beverages may produce gas, raising the pressure inside the product and causing the Lid Set to burst.

Never fill the product with the following:

- Dry ice or carbonated drinks
- Liquids high in sodium such as soup or Kobu-cha
- Dairy products or fruit juice
- Fruit pulp or tea leaves

Avoid the following as dropping the product is dangerous.

- Carry the product by the Lid Cover or Sip Area.
- Hold the Bottom Cover and turn the product upside down.

Do not swing the product by the Handle.

Leave 1cm (1/2-inch) room on top when filling the Main Body.

Drink Level

Leave 1cm (1/2-inch) space below the rim (part A)
Inside of the Main Body

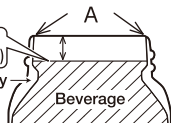

Make sure that there is no beverage leakage before using the product.

Avoid dropping or hitting against hard surfaces.

Never remove the sticker on the bottom of the Main Body.



Thoroughly clean the inside and outside of the Main Body (Mouth) and Lid Set after every use. Be particularly careful after filling the product with sports drinks.

Do not place near heat sources such as gas stoves, ovens, and heaters, as doing so may cause deformation or discoloration of the product.

Do not bite or pull strongly on the Sip Area.

Break ice cubes into smaller pieces, as failure to do so may cause deformation of the Main Body and leakage.

Do not scratch or rub the design on the outside of the Main Body strongly using fingernails or hard objects, as this may cause the design to come off.

Place the product vertically when carrying it in a bag to prevent leakage or condensation.

When placing the product in a bag, etc., be careful not to press the Button or turn the Handle, as doing so may cause leakage.

Never do the following as beverages may spurt out of the Sip Area if vibration or impact is applied, or the internal pressure of the product rises.

- Leaving the Lid Cover open.
 - Attaching or detaching the Lid Set to the Main Body with the Lid Cover open.
-

If any drink remains inside the Sip Area, it may splash out when you open the Lid Cover.

Note: The rattling noise that may be heard when the Main Body is shaken comes from the metallic foil used in the vacuum insulation to increase cold retention, and does not indicate a malfunction.

How to Use:

- Follow the instructions for care and wash the product thoroughly before use.
- When you first use the product, there may be a plastic smell. However, this will become less noticeable with use.

Opening and Closing the Lid Cover

- Open and close the Lid Cover with the Main Body in an upright position.

How to open

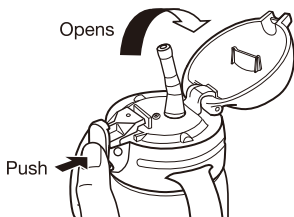

How to close



How to Disassemble the Lid Set:

1 Remove the Straw Set.

- Open the Lid Cover, hold the straw attachment area of the Straw Set, and remove it from the Stopper Cover.

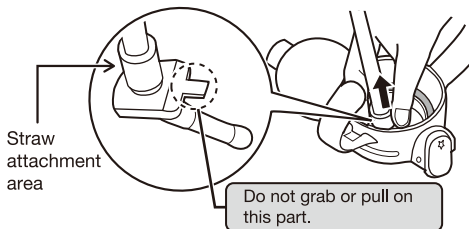

2 Remove the Straw from the Sip Area.



3 Remove the Stopper Gasket.

- Hold the tab on the Stopper Gasket and remove it from the Stopper Cover.



How to Assemble the Lid Set:

1 Attach the Stopper Gasket.

- Make sure to push the Stopper Gasket into the recess of the Stopper Cover with the Tab outward.
- If there are any loose areas of the Stopper Gasket, adjust them so that it is even.

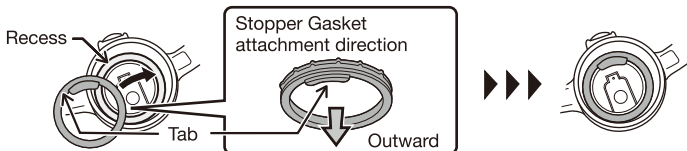

2 Attach the Straw to the Sip Area.

- Insert the Straw into the hole at the bottom of the Sip Area until it cannot go any further.



3 Attach the Straw Set.

- ① With the ridge of the Sip Area on the Button side of the Stopper Cover, pass the tip of the Sip Area through the hole in the Stopper Cover.

Button side

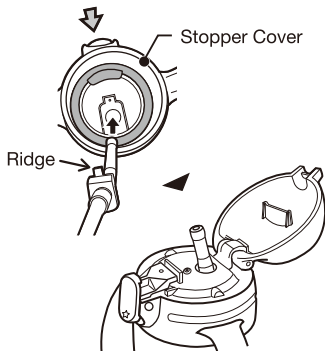

- ② Pull up the tip of the Sip Area in the direction of the arrow and firmly set it. (If the Straw Set is not set correctly, this may cause contents to leak.)

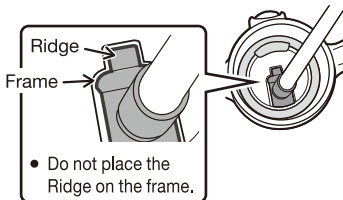
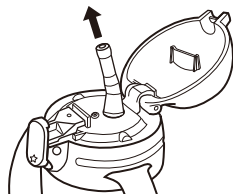

How to Take Care of Your Product:

- Clean the product after each use to prevent odors and mold, and to keep the product sanitary.
- Always disassemble the product before cleaning.

When Cleaning Your Product:

- Do not boil or use a dishwasher or dish-dryer.
- Do not clean using paint thinner, polishing powders, abrasive cleansers, scrub brushes (nylon, metal wire, etc.), melamine sponges, the nylon side of an abrasive sponge, or any similar items.
- Do not use bleach as it may damage the product.
Zojirushi's designated cleaning detergent SB-ZA01E may be used to clean the interior of the Main Body and the Lid Set.
- The Main Body is fully washable, but do not soak it in water for an extended period of time.
- If the product is not going to be used for an extended period, wash thoroughly and dry well. Store the product away from high temperatures and humidity.

Regular Care

- ① Wash the Lid Set, the outside of the Main Body, and the Bottom Cover with mild kitchen detergent diluted with lukewarm water using a sponge, and the inside of the Main Body using a soft sponge with a handle.
Use a small brush if necessary.
 - ② Rinse, wipe away remaining water, and leave to dry thoroughly.
- Streaks and smudges caused by rubbing on the coated portion of the Main Body that cannot be removed in the above process can be removed using a soft eraser.
 - Thoroughly flush the inside of the Sip Area and Straw with strong running water.

Dealing with Stubborn Dirt

Rust Spots and Water Stains

- ① Fill the Main Body with hot water with 10% vinegar without attaching the Lid Set.
- ② After 30 minutes to an hour, wash the interior thoroughly.

Tea and Other Stains

Remove the Lid Set and use Zojirushi's cleaning detergent SB-ZA01E (sold separately).

- The Stopper Gasket, Straw Set and Bottom Cover are consumable parts. Check them about once a year.
- The resin used in the Lid Set is safe and hygienic for food contact. However, if the surface becomes rough or damaged, please replace it (additional charge.)