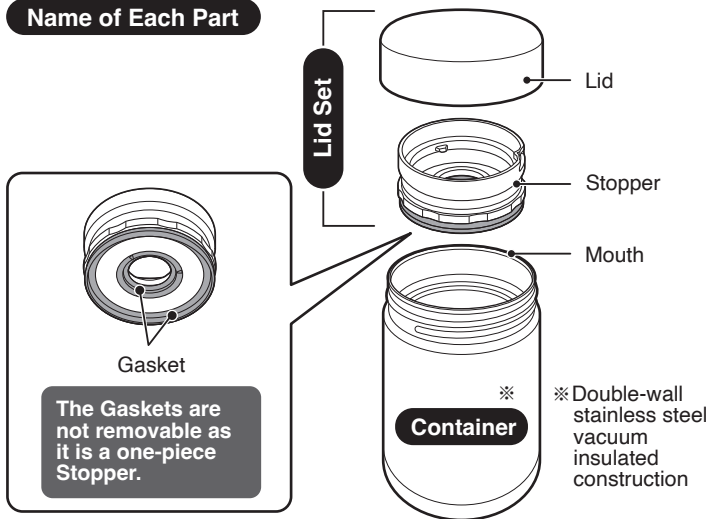

Name of Each Part

- Please read these instructions before use, and keep for future reference.
- The illustrations used in this instruction manual may differ from the actual product you have purchased.

Important Safeguards

Be sure to follow the instructions.

These WARNINGS and CAUTIONS are intended to prevent property damage or personal injury to you and others.

■ The degree of danger or damage by the misuse of the product is indicated as follows:

WARNING

Indicates risk of serious injury or death.

CAUTION

Indicates risk of injury or property damage if mishandled.

■ Prohibited or required actions are indicated as follows:



Indicates a prohibited operation.



Indicates a requirement or instruction that must be followed.



WARNING



Do not allow infants or small children to use this product. Keep out of the reach of infants and small children.



CAUTION



When using filled with hot foods or beverages:

- Drink or eat slowly without tilting the Container suddenly.



Do not attach parts other than those specifically designed for this product.

Do not disassemble the product (other than parts designed to be disassembled).

Do not shake the product forcefully.

Do not use the product if its thermal insulation performance has deteriorated.

Do not use if water enters the Vacuum Layer.

Drinking the water that seeps out from the Vacuum Layer may cause illness.

Vacuum Layer



Do not forcibly remove the Gasket from the Stopper. It is not removable. Do not use if the Gasket is damaged or coming off.

Do not hold the product by the Lid Set when carrying, as the product may fall and cause injuries.

Do not use this product for other than storing and keeping foods and beverages hot or cold.

Do not place near heat sources such as gas stoves, ovens, and heaters, as doing so may cause deformation or discoloration of the product.

Do not heat in a microwave, as doing so may cause sparks.

Do not place near open flames (from gas stoves, etc.), on top of electric heaters, or IH cooking devices, as doing so may cause a fire or malfunction.

Avoid dropping or hitting against hard surfaces.

Do not place cans, bottles, etc. inside the Container.

Do not drink out of the product while driving.

Never put the following into the product:

- Dry ice or carbonated drinks
- Perishable fresh foods (uncooked meat, seafood, dairy products, eggs, etc.)

Do not scratch or rub the design on the outside of the Container strongly using fingernails or hard objects, as this may cause the design to come off.

Do not remove the sticker on the bottom of the Container.

Sticker





Do not heat the product from the outside, even when the Lid Set is difficult to remove.

Doing so may increase the pressure inside the Container and cause the Lid Set to fly off; damage and burst the Lid Set; or cause foods or beverages to spray out; which could all result in injury.

- Use a non-slip soft material such as rubber gloves and open with the product at an upright position.

Avoid leaving in direct sunlight for an extended period.

Do not place objects directly on top of the Lid Set. These may absorb heat from the Lid Set.



Fill the Container only up to the level shown in the illustration.

Fill level

Leave a bit of space below the rim (part A).

Inside of the Container

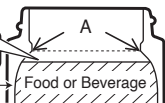

Always make sure cold soups or foods and beverages containing dairy products are cooked (heated) through before placing them in the Container.

Follow these instructions when placing salads/fruit in the Container.

- Use fresh (just purchased) salads/fruit. Wash well under running water before using.
- Wash hands thoroughly before preparing foods.
- Avoid using kitchen knives and chopping boards which have been used for meat or fish. If you do use such knives or boards for salads/fruit, disinfect them beforehand.
- Cut salads/fruit and cool well in the refrigerator before placing in the Container.

Always assemble the Lid Set before using.

Make sure food or beverage does not leak before using the product.

Consume food or beverages as soon as possible (within 6 hours) and finish them in one sitting.

Thoroughly clean the Container, the Lid, and the Stopper immediately after every use.

In particular, placing foods and beverages with strong odors in the Container may cause odor transfer.

To prevent leakage, place the product vertically when carrying it in a bag and be careful that it does not tip over.

Note: The rattling noise that may be heard when the Container is shaken comes from the metallic foil used in the vacuum insulation to increase heat (cold) retention, and does not indicate a malfunction.

Note: You may hear a pop when opening the Lid Set. It is the sound of internal pressure being relieved and does not indicate a malfunction.

How to Use:

- Follow the instructions for care and wash the product thoroughly before use.
- When you first use the product, there may be a plastic smell. However, this will become less noticeable with use.
- Even if the Stopper feels loose when you attach the Lid Set to the Container, it is attached correctly.

Designed to release pressure when opening.

- While removing the Lid Set some resistance may be experienced midway. This is normal. Please keep turning it to remove.
- The Stopper may feel loose when removing the Lid Set. This is not a malfunction.

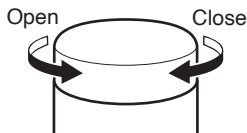

How to Disassemble the Lid Set:

- 1 Turn the Stopper in the direction of the arrow until it stops

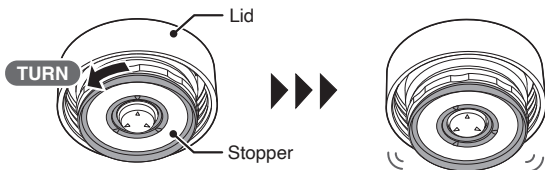

- 2 Turn the Stopper while pulling it in the direction of (a) to remove it

You may feel some resistance from the Stopper. This is normal. Keep turning it to remove it.

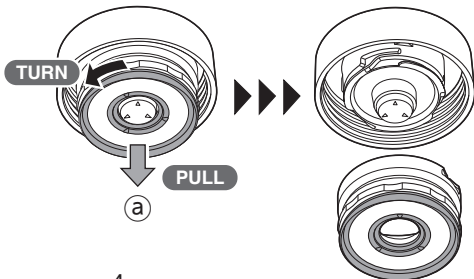

Assembling the Lid Set:

- 1** Align the Δ on the Lid with the ∇ on the Stopper.

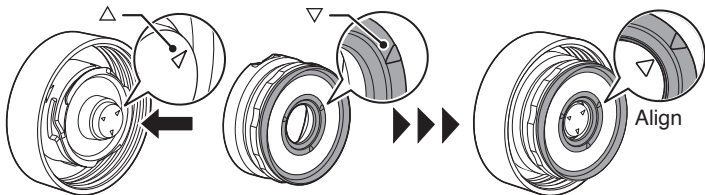

- 2** Turn the Lid in the direction of the arrow to align the next Δ on the Lid with the ∇ on the Stopper.

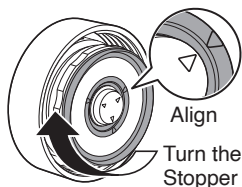

How to Take Care of Your Product:

- Clean the product after each use to prevent odors and mold, and to keep the product sanitary.
- Always disassemble the product before cleaning.

When Cleaning Your Product:

Please follow these instructions to prevent damage to the product:

- Do not boil.
- Do not clean using paint thinner, polishing powders, abrasive cleansers, scrub brushes (nylon, metal wire, etc.), melamine sponges, the nylon side of an abrasive sponge, or any similar items.
- Do not use bleach as it may damage the product.
Zojirushi's designated cleaning detergent SB-ZA01E may be used to clean the interior of the Container and the Lid Set.
- The Container is fully washable, but do not soak it in water for an extended period of time.
- Avoid damaging the inside of the Container when cleaning.
- If the product is not going to be used for an extended period, wash thoroughly and dry well. Store the product away from high temperatures and humidity.

How to Take Care of Your Product: continued

How to Clean

Hand wash is recommended for extended use.

- ① Wash using warm water and mild dishwashing liquid with a sponge.
Use a small brush or a soft sponge brush with a handle to wash parts that are difficult to wash.
- ② Rinse, leave to dry so there is no remaining water.
 - If streaks, smudges or color transfer caused by rubbing on the coated portion of the Container cannot be removed by the above method, try using a soft eraser. If it still cannot be removed, rub using warm water and mild dishwashing liquid with a sponge.

If using a dishwasher:

- Please review the instruction manuals for the dishwasher and detergent before using.
- Do not use a commercial dishwasher or dish dryer.
- Do not drop the Lid and Stopper onto the heating element.
Doing so may cause fuming or deformation.
- Do not touch the product immediately after washing and drying as it may be hot.
- Do not press the Container firmly against the rack.
Doing so may cause damage or deformation of the Container, or the coating, printing, and/or stickers to peel off.
- Disassemble the Lid Set before washing and drying.
- Do not forcefully insert the Lid and Stopper into the rack or wash and dry the Lid and Stopper with a heavy object on top of them.
Doing so may cause deformation, etc.
- Parts of the exterior of the Container may become lightened from cleansers or water stains. If this occurs, pour hot water over the discolored portion, and then immediately wipe it with a dry, soft cloth.
Be careful not to scald yourself.

How to Clean Rust Spots and Water Stains

- ① Fill the Container with hot water with 10% vinegar.
- ② Leave for 30 minutes to an hour without attaching the Lid Set.
- ③ Wash the interior thoroughly.

What to Do If the Product Absorbs Odors

Wash thoroughly and dry with a soft cloth.
Place in the sun and let dry for 1-2 hours.

Replacing the Lid Set:

We take care in only using materials that are safe and hygienic for food contact. However, if plastic parts become damaged or their surface becomes rough, please replace them for optimum performance. The Lid Set may need to be replaced due to time and wear. Please check it about once a year. When replacing parts, please record the model number and part name beforehand. Then contact either the store where you purchased the product or Zojirushi Customer Service. Replacement parts may be available for an additional charge.